

Material
S45C HQI (Induction Hardening)

ORDERING METHOD

MGP - 50200

Parts No.

Ex.: ϕ D50mm \times L200mm

- This product is suitable for the OILES Guide Bush.
- The tap for hanging (M12 depth 25) is cut and on the middle of the edge face on the sliding face side of the MGP-80250~MGP-100400.
- For hardening, the hardness is HRC55 or more.

Guide Post Option

Option

Tap-holes on the edge face of the installation side of the guide post may also be machined.

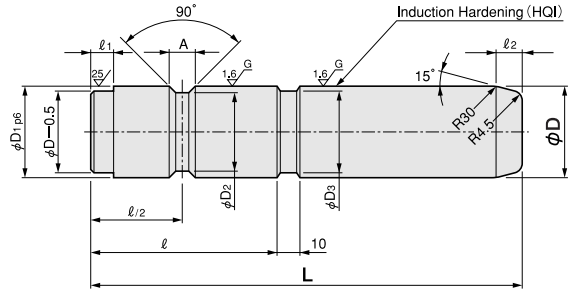
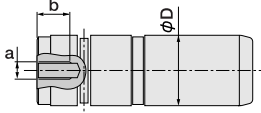

Option Code	Nominal dimension	a	b
MT	25	—	—
	30	M12	25
	40	M12	25
	50	M12	25
	60	M12	25
	80	M12	25
	100	M16	32

ORDERING METHOD

MGP - 50200 - MT

Parts No. Option code

Example: In case when adding tap holes for a diameter of 50mm and length of 200mm.

Parts No.	ϕD	ϕD_{1p6}	ϕD_2	ϕD_3	L	ℓ	ℓ_1	ℓ_2	A
MGP-2580	25	25	21	24	80	30			
MGP-25100					100				
MGP-25120					120				
MGP-30100	30	30	26	29	100	40	5	5	8
MGP-30120					120				
MGP-30140					140				
MGP-40120	40	40	36	39	120	50			
MGP-40140					140				
MGP-40160					160				
MGP-50160	50	50	45	49	160	70			10
MGP-50200					200				
MGP-50250					250				
MGP-60200	60	60	55	59	200	90			
MGP-60250					250				
MGP-60300					300				
MGP-80250	80	80	75	79	250	120	10	10	
MGP-80300					300				
MGP-80350					350				
MGP-100300	100	100	95	99	300	150			
MGP-100350					350				
MGP-100400					400				

CAD