

**Material**  
OILES#500SP (High tension brass with graphite plugs.)

**ORDERING METHOD**

**SGF - 658080**

Parts No.

Ex.:  $\phi d65\text{mm} \times \phi D80\text{mm} \times L80\text{mm}$

● The operation direction is both the reciprocal direction and the rotation direction.

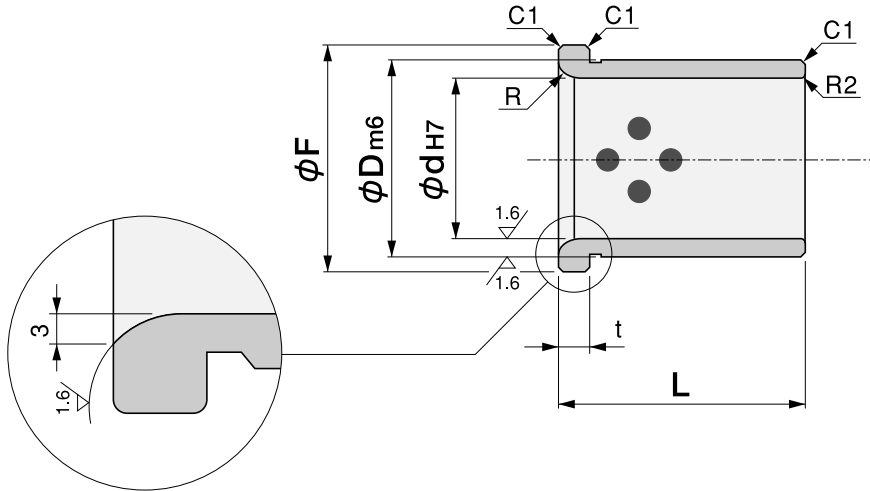

Parts No.	$\phi d_{H7}$	$\phi D_{m6}$	$\phi F$	L	t	R
<b>SGF-253540</b>	25 $\begin{matrix} +0.021 \\ 0 \end{matrix}$	35 $\begin{matrix} +0.025 \\ +0.009 \end{matrix}$	45	40	7	10
<b>SGF-304050</b>	30	40	50	50		
<b>SGF-405570</b>	40 $\begin{matrix} +0.025 \\ 0 \end{matrix}$	55	65	70		
<b>SGF-506580</b>	50	65	75			
<b>SGF-607580</b>	60	75 $\begin{matrix} +0.030 \\ +0.011 \end{matrix}$	85	80		
<b>SGF-658080</b>	65 $\begin{matrix} +0.030 \\ 0 \end{matrix}$	80	90		10	20
<b>SGF-6580120</b>				120		
<b>SGF-80100100</b>	80	100	110	100		
<b>SGF-80100140</b>				140		
<b>SGF-100120100</b>	100 $\begin{matrix} +0.035 \\ 0 \end{matrix}$	120 $\begin{matrix} +0.035 \\ +0.013 \end{matrix}$	130	100		
<b>SGF-100120140</b>				140		

**CAD**